



HERITAGE

- REDROW -

THE SHAFTESBURY

FOUR BEDROOM DETACHED HOME

 **REDROW**

THE SHAFTESBURY



GROUND FLOOR

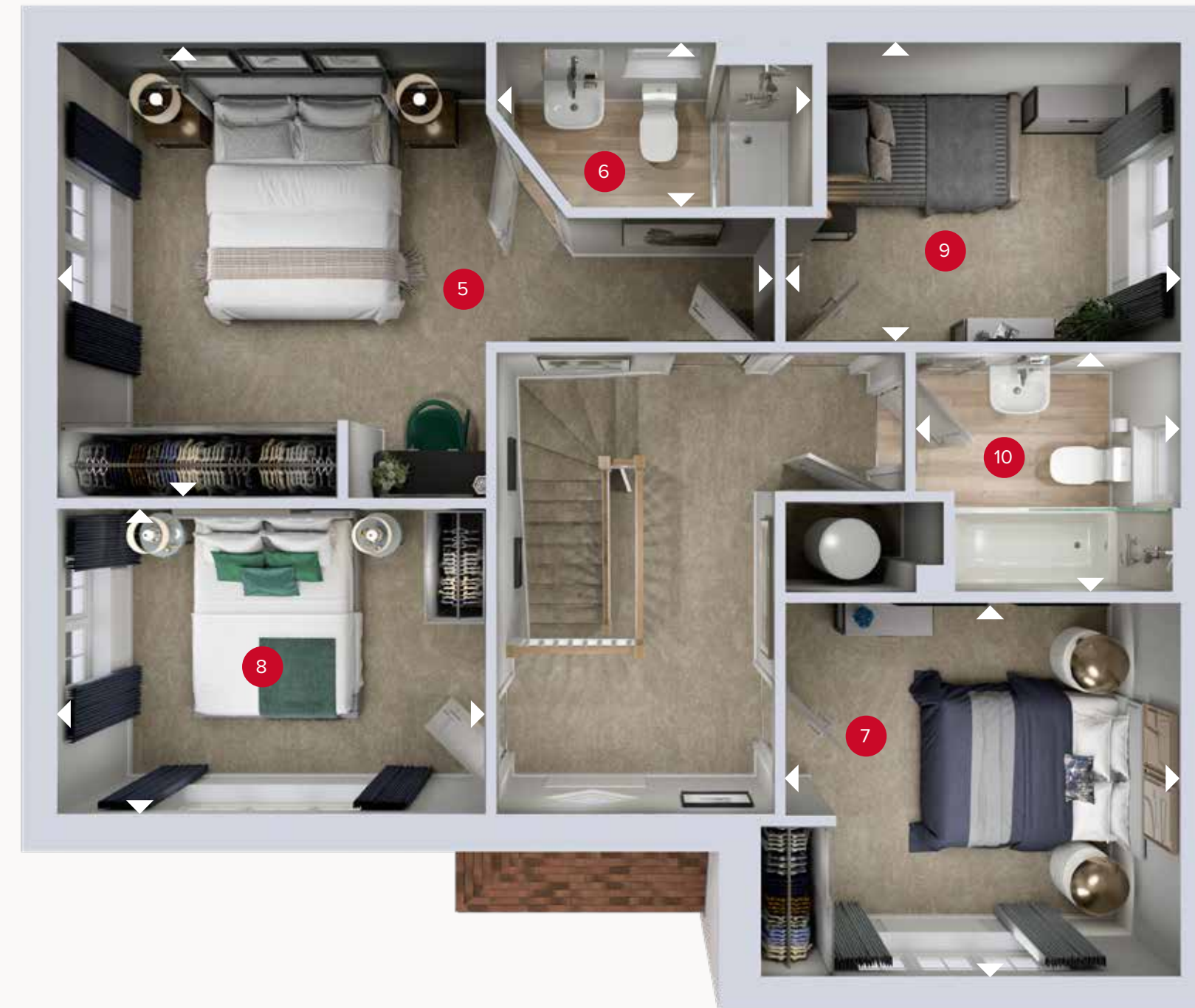

FIRST FLOOR

GROUND FLOOR

1	Kitchen/Dining/ Family	25'3" x 11'8"	7.72 x 3.56 m
2	Lounge	20'10" x 11'8"	6.37 x 3.56 m
3	Utility	6'5" x 5'10"	1.98 x 1.79 m
4	Cloaks	6'5" x 3'1"	1.98 x 0.96 m

FIRST FLOOR

5	Bedroom 1	19'7" x 12'2"	5.97 x 3.73 m
6	En-suite	8'5" x 4'5"	2.58 x 1.35 m
7	Bedroom 2	10'11" x 9'11"	3.34 x 3.04 m
8	Bedroom 3	11'10" x 8'4"	3.62 x 2.55 m
9	Bedroom 4	10'11" x 8'0"	3.34 x 2.45 m
10	Bathroom	7'4" x 6'8"	2.26 x 2.05 m