



**HERITAGE**

- REDROW -

# THE HENLEY

FOUR BEDROOM DETACHED  
ECO ELECTRIC HOME

 **REDROW**

# THE HENLEY

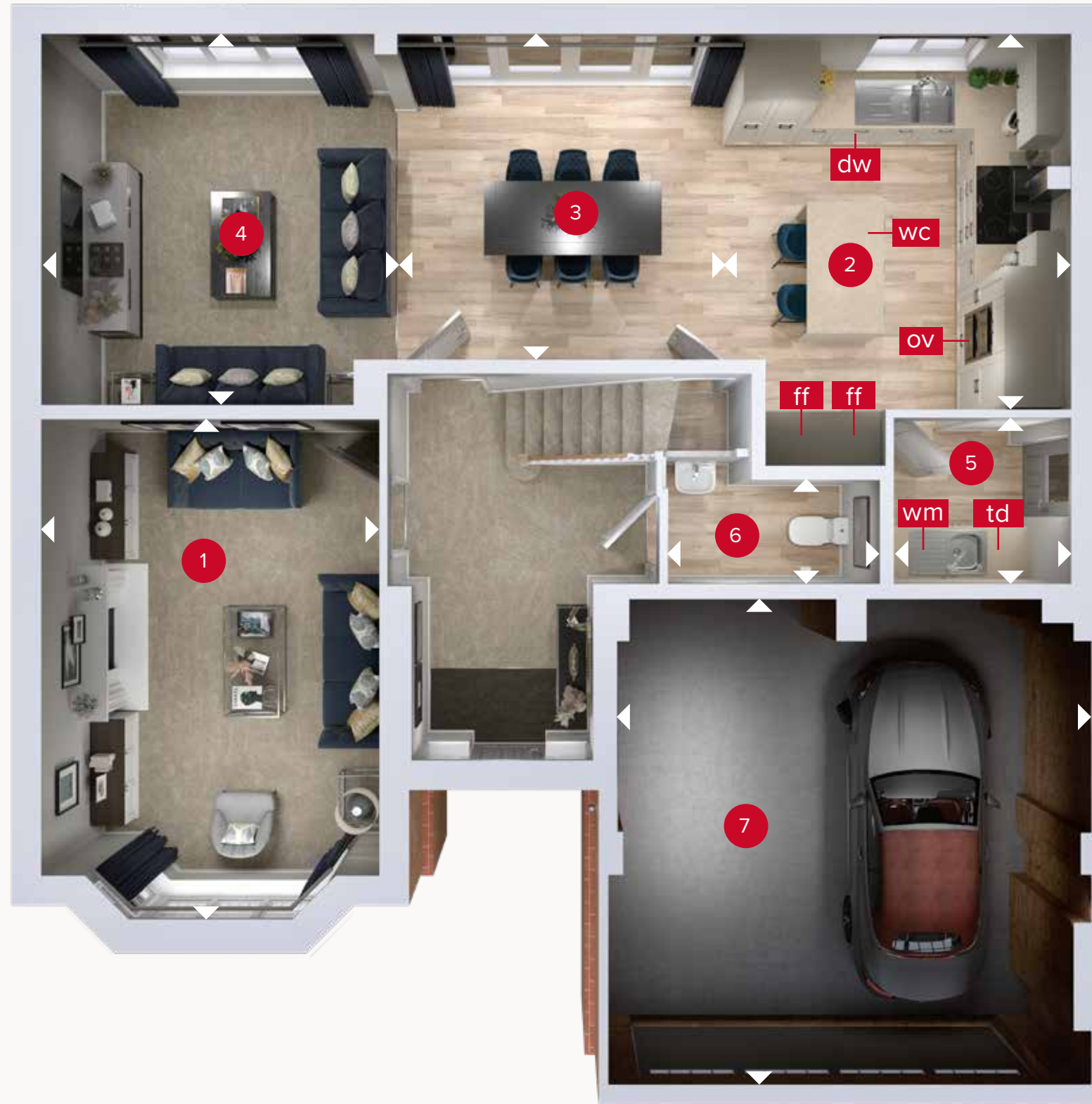

**GROUND FLOOR**



**FIRST FLOOR**

## GROUND FLOOR

1	Lounge	17'7" x 11'9"	5.37 x 3.57 m
2	Kitchen	13'4" x 11'5"	4.07 x 3.49 m
3	Dining	13'1" x 11'9"	3.99 x 3.57 m
4	Family	13'3" x 11'6"	4.03 x 3.51 m
5	Utility	6'8" x 5'11"	2.03 x 1.80 m
6	Cloaks	7'3" x 3'7"	2.20 x 1.10 m
7	Garage	17'1" x 17'0"	5.21 x 5.19 m

## FIRST FLOOR

8	Bedroom 1	16'8" x 11'9"	5.09 x 3.57 m
9	En-suite 1	10'10" x 6'4"	3.29 x 1.94 m
10	Bedroom 2	14'4" x 10'2"	4.37 x 3.11 m
11	En-suite 2	7'6" x 5'4"	2.28 x 1.63 m
12	Bedroom 3	11'11" x 10'0"	3.63 x 3.05 m
13	Bedroom 4	12'5" x 8'6"	3.78 x 2.59 m
14	Bathroom	8'4" x 7'9"	2.54 x 2.37 m



09.04.2024

Customers should note this illustration is an example of the Henley house type. All dimensions indicated are approximate and the furniture layout is for illustrative purposes only. Homes may be "handed" (mirror image) versions of the illustrations, and may be detached, semi-detached or terraced. Materials used may differ from plot to plot including render and roof tile colours. Detailed plans and specifications are available for inspection for each plot at our Customer Experience Suite or Sales Centre during working hours and customers must check their individual specifications prior to making a reservation. Please note that the specification show in this plan may include optional upgrades from standard specification. Please speak with your Sales Consultant for more information. 01151-09 EG\_HENL\_DM.2

▷ Denotes where dimensions are taken from. All wardrobes are subject to site specification. Please see Sales Consultant for further details.

ov - oven  
ff - fridge freezer  
dw - dishwasher  
wm - washing machine space  
td - tumble dryer space  
wc - wine cooler

