



HERITAGE

- REDROW -

THE LEDSHAM

FOUR BEDROOM DETACHED HOME

 **REDROW**

THE LEDSHAM

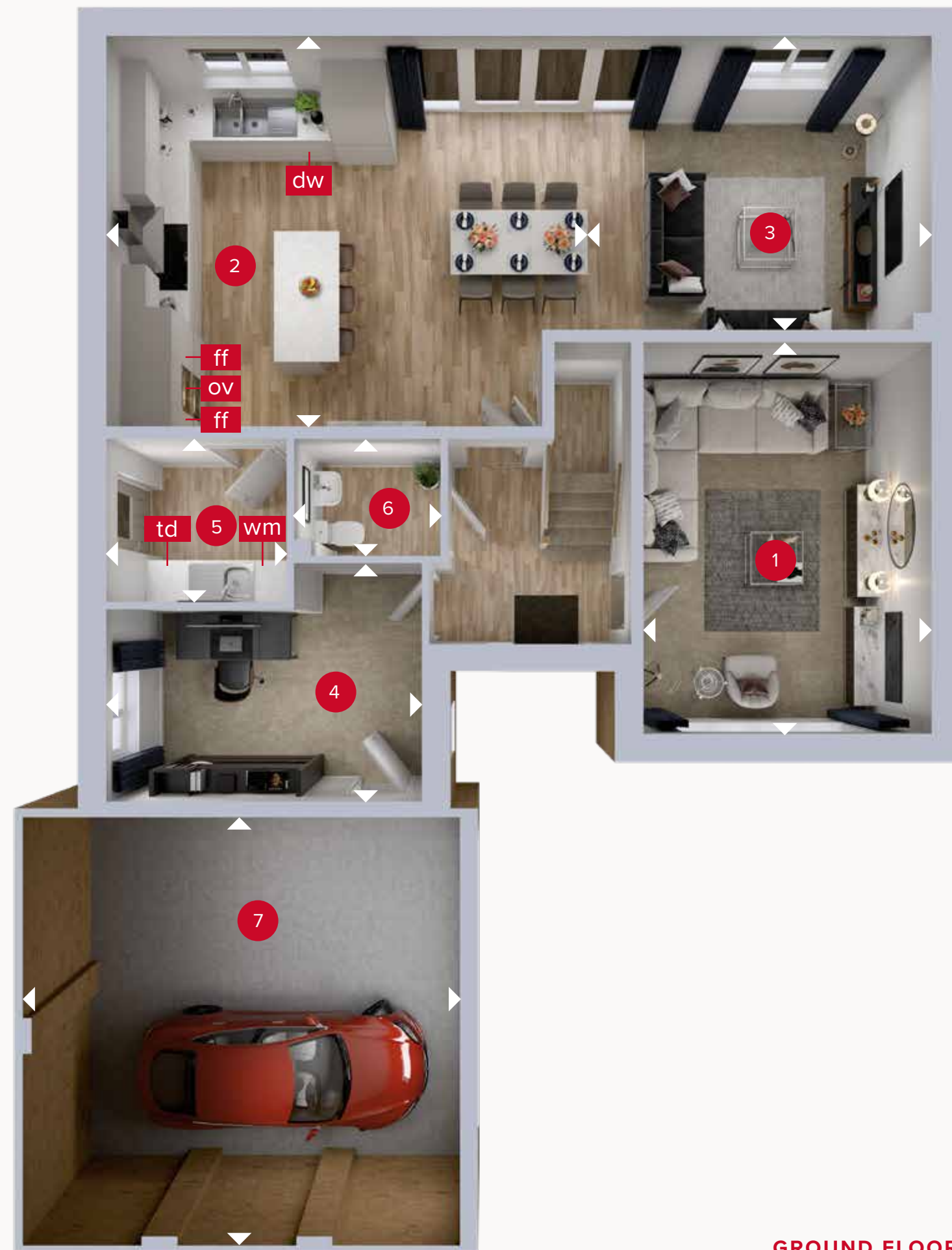

GROUND FLOOR

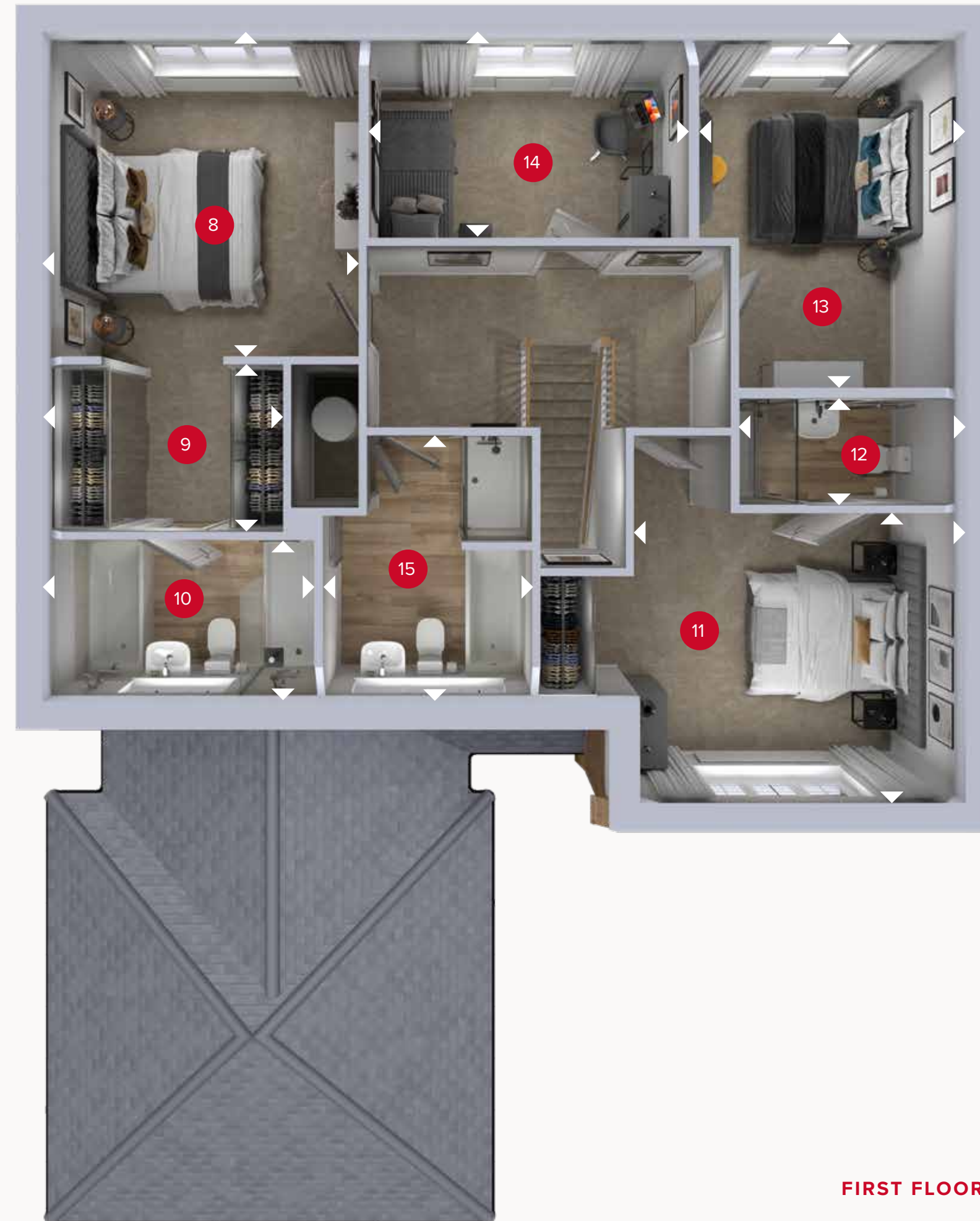

FIRST FLOOR

GROUND FLOOR

1 Lounge	15'11" x 11'8"	4.84 x 3.57 m
2 Kitchen/Dining	19'10" x 16'0"	6.05 x 4.87 m
3 Family	13'8" x 11'11"	4.16 x 3.63 m
4 Study	12'10" x 7'10"	3.90 x 2.38 m
5 Utility	7'4" x 6'8"	2.23 x 2.02 m
6 Cloaks	5'11" x 4'9"	1.81 x 1.45 m
7 Garage	17'9" x 17'5"	5.41 x 5.30 m

FIRST FLOOR

8 Bedroom 1	11'11" x 11'5"	3.63 x 3.49 m
9 Dressing Room	8'8" x 6'2"	2.65 x 1.88 m
10 En-suite 1	9'10" x 6'0"	3.00 x 1.82 m
11 Bedroom 2	11'11" x 10'8"	3.63 x 3.24 m
12 En-suite 2	8'2" x 3'11"	2.49 x 1.19 m
13 Bedroom 3	13'1" x 9'8"	3.99 x 2.93 m
14 Bedroom 4	11'8" x 7'7"	3.55 x 2.31 m
15 Bathroom	9'9" x 7'9"	2.98 x 2.36 m